

Rollers™ Portable Table Assembly Instructions

STEP 1: Attache Rollers™ Portable Table Top to the Genufold (see page 2 for next steps).



Bottom of table with
(11) pre-drilled
mounting holes.

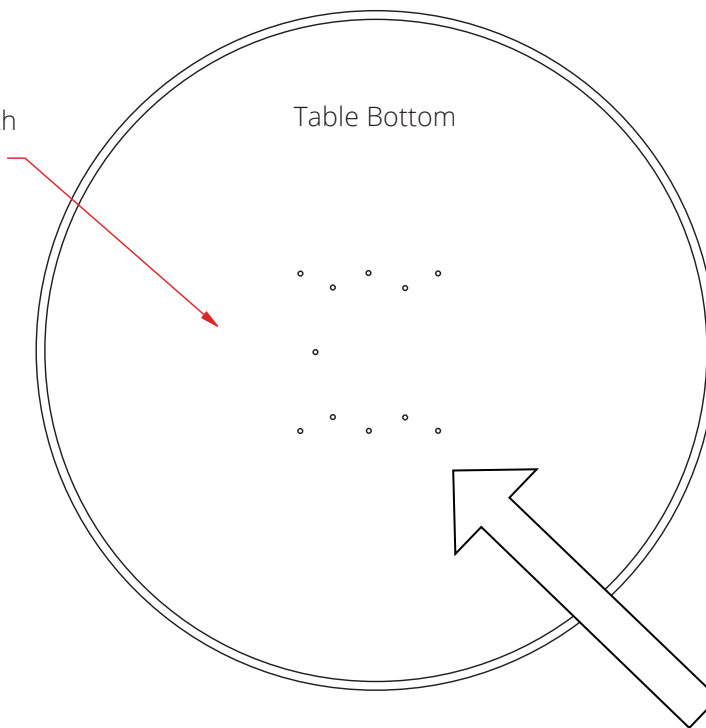
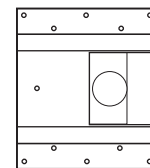
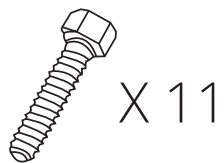
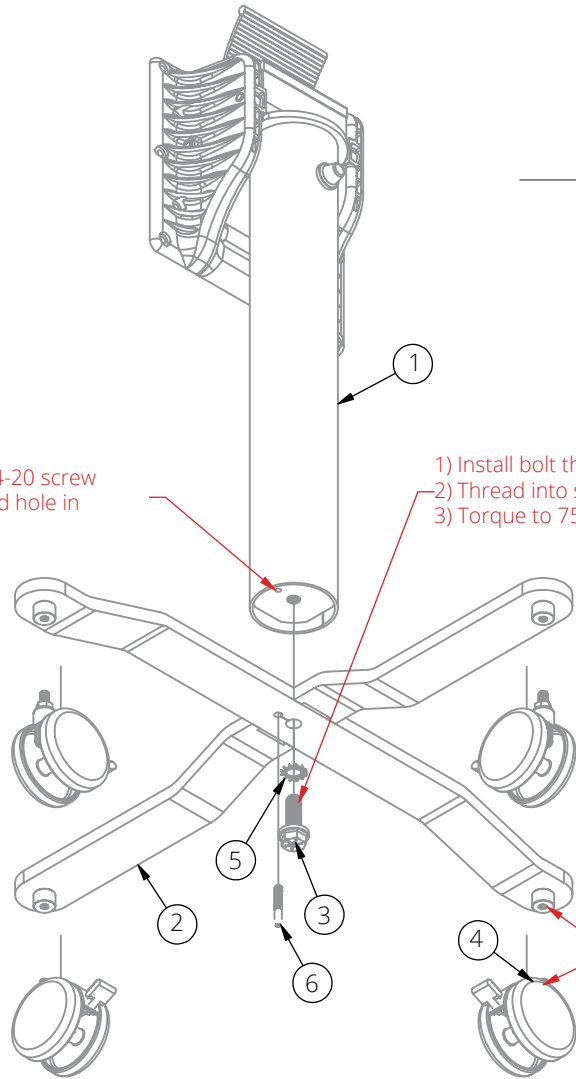

Table Bottom

Align hinge mechanism iwth
pre-drilled holes on table bottom
and attach using a 5/16" nut
driver to install (11) provided
#12-24 x 3/4" drill tip screws into
pre-drilled holes.



Thread 1/4-20 screw into tapped hole in mainbar



- 1) Install bolt thru star washer and 9/16" hole in mainbar
- 2) Thread into strap in bottom of column
- 3) Torque to 75 ft lbs.

- 4) Thread caster (or leveler) stem into insert on bottom of mainbar and tighten snug with an open end wrench

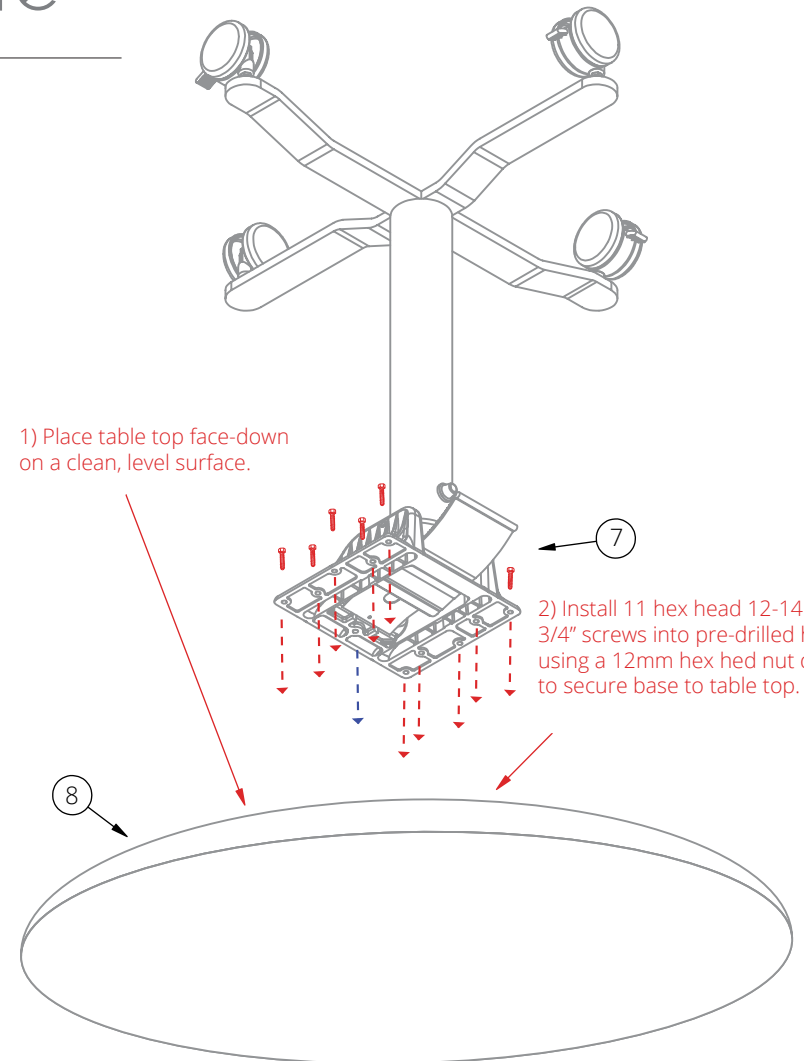

- 1) Place table top face-down on a clean, level surface.

- 2) Install 11 hex head 12-14 x 3/4" screws into pre-drilled holes using a 12mm hex head nut driver to secure base to table top.

Parts List		
Seq	Qty	Description
1	1	317 Column Assembly - Nesting X-Base
2	1	317N Mainbar Wldt
3	1	1/2 X 1 1/2 Flange Head Bolt
4	4	3" DIA Locking Caster - 1/2" Stem
5	1	Star Washer
6	1	1/4"-20 X 1 1/2" Button Head Socket Cap Screw
7	11	12-14 x 3/4" Self-Drilling, Self-Tapping Hex-Head Screws
8	1	Table Top